

Feature

- International standard pack
- Low forward voltage drop
- Isolation voltage 2500V ~

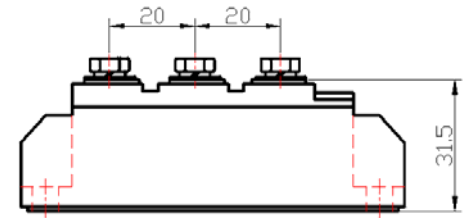

Application

- AC/DC motor control
- All types of rectifier power supply
- Frequency convertor

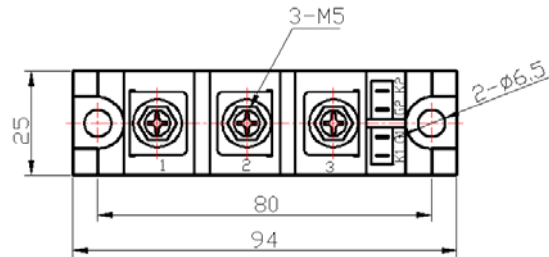
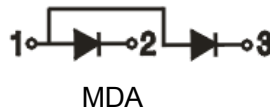

Maximum value

| Symbol | Parameter | Rating | | | Unit |
|-----------|-------------------------------------|-------------------------------------|-------------------------------------|-------------------------------------|------|
| | | MDC110-12 MDA110-12 MDK110-12 | MDC110-16 MDA110-16 MDK110-16 | MDC110-20 MDA110-20 MDK110-20 | |
| V_{RRM} | Peak reverse repetitive voltage | 1200 | 1600 | 2000 | V |
| V_{RSM} | Peak reverse non-repetitive voltage | 1300 | 1700 | 2100 | V |

| Symbol | Parameter | Test condition | Rating | Unit |
|--------------|-----------------------------------|---|-------------|----------------------|
| $I_{F(AV)}$ | Average forward current | 180° sine half-wave 50HZ single-sided heat dissipation $T_c=100^\circ\text{C}$ | 110 | A |
| $I_{F(RMS)}$ | Forward RMS current | single-sided heat dissipation, 180° sine half-wave, 50HZ, $T_c:100^\circ\text{C}$ | 173 | A |
| I_{FSM} | Forward surge current | $t=10\text{ms}, 50\text{HZ}, \sin, T_{jm}$ | 2600 | A |
| I^2t | I^2t value | $V_R = 0.6V_{RRM}, T_{jm}$ | 34400 | A^2S |
| V_{ISO} | Isolation voltage | AC one minute | 2500 | V |
| T_j | Operating junction temperature | | -40 to +150 | $^\circ\text{C}$ |
| T_{jm} | Rated junction temperature | | 150 | $^\circ\text{C}$ |
| T_{stg} | Storage temperature | | -40 to +125 | $^\circ\text{C}$ |
| Md | Mounting torque (copper plate) M6 | | 6 | N·m |
| | Mounting torque (terminal) M5 | | 4 | N·m |
| W_t | Weight | | 160 | g |

Electrical characteristics

| Symbol | Parameter | Test condition | Rating | Unit |
|---------------|-----------------------------------|---|--------|--------------------|
| I_{RRM} | Peak reverse repetitive current | $V_R=V_{RRM}$, sine half-wave, $T_j=150^\circ\text{C}$ | 8 | mA |
| V_{FM} | Peak forward voltage | $I_{FM}=330\text{A}$, $T_j=25^\circ\text{C}$ | 1.45 | V |
| $R_{th(j-c)}$ | Thermal impedance (junction-case) | Single-sided heat dissipation, sine half-wave | 0.35 | $^\circ\text{C/W}$ |